

Lavington Park

Near Petworth | West Sussex



SITE PLAN



This site plan is a guide for illustrative purposes only. Landscaping shown is indicative only.

No. 11

No. 11 at Lavington Park is an attractive 1939 sq ft 4 bedroom detached house with a detached double garage. This house is designed and built to a high specification with integrated appliances to the spacious kitchen and breakfast area which leads onto a separate dining area through double doors. The master bedroom has fitted wardrobes and the added luxury of an en-suite whilst bedrooms 2 and 3 also benefit from fitted wardrobes. A stunning garden completes this property and can be accessed through French doors from the living and dining rooms as well as the study.

Ground Floor

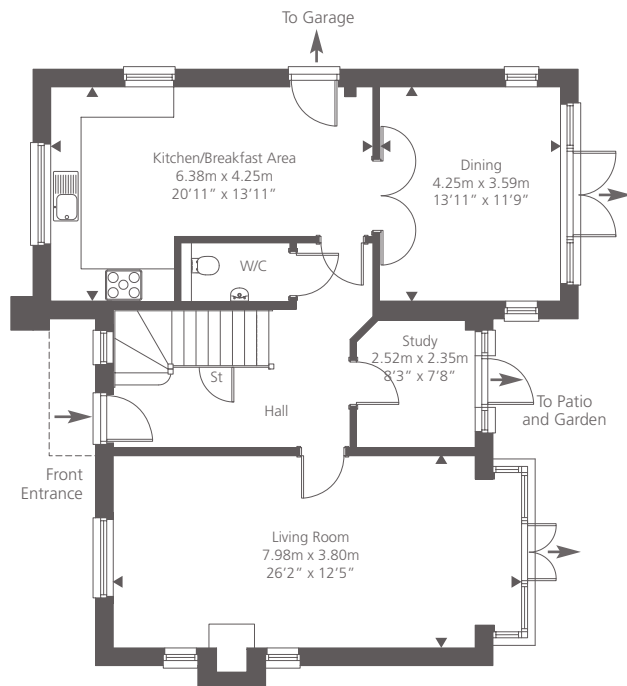

First Floor

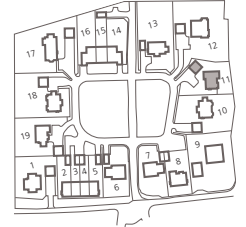

For more information please call 01372 225007

shanlyhomes.com

◀ Point from which maximum dimensions are measured. Dimensions are intended for guidance only and may vary by plus or minus 7.6m/3". 'W' denotes wardrobe, 'CYL' denotes hot water cylinder. The plots shown indicate general layout and may vary slightly. Please consult a Sales Advisor for more information.

SHANLY
HOMES