

No.10 (h) Wickham Rise

Speldhurst Road | Southborough | TN4 0DT

WICKHAM RISE

SOUTHBOROUGH



Computer-generated image of Plots 9 & 10, Wickham Rise.



This site plan is a guide for illustrative purposes only. Landscaping shown is indicative only.

No. 10 is a highly specified three bedroom semi-detached house. Downstairs includes a well proportioned kitchen / family area with a separate living room as well as a w/c. Upstairs, bedrooms 1 and 2 are equipped with built in wardrobes, with bedroom 1 also having an en-suite. Bedroom 3 can double up as the perfect work from home space.

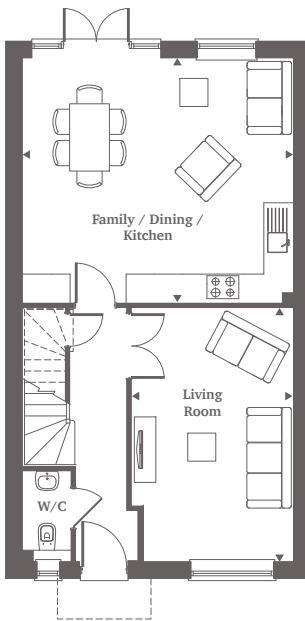

Ground Floor

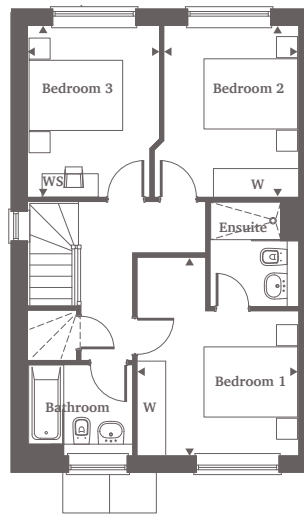

First Floor

Ground Floor

- Living Room
5.39m x 3.43m 17'8" x 11'3"
- Kitchen/Dining/Family
5.75m x 5.21m 18'10" x 17'1"

First Floor

- Bedroom 1
4.20m x 3.42m 13'9" x 11'3"
- Bedroom 2
3.63m x 2.85m 11'11" x 9'4"
- Bedroom 3
3.63m x 2.78m 11'11" x 9'1"

For more information please call 01372 225 007
shanlyhomes.com



◀ Point from which maximum dimensions are measured. Dimensions are intended for guidance only and may vary by plus or minus 7.6cm/3". The plots indicate general layout only which may vary from other plots. Kitchen and bathroom layouts indicative only. W denotes wardrobe. S denotes storage. LC denotes linen cupboard. WS denotes work space. (h) denotes handed plot layout. Please contact sales consultant for more information.